

Evansville, IN  
Jasper, IN  
Vincennes, IN

812-477-0077  
812-482-5105  
812-882-4090



Henderson, KY  
Owensboro, KY  
Mt. Vernon, IL

270-830-0077  
270-684-0877  
618-244-7156

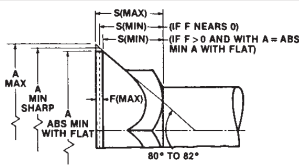

### Plow Bolts (GR. 5 And 8)

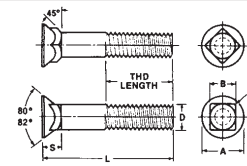

Basic Diameter	A Diameter of Head			F Feed Thickness	S Depth of Square and Head		B Width of Square		R Radius on Corners of Square
	Max.	Sharp	Flat Min.	Max	Max.	Min.	Max.	Basic Min.	Max.
	5/16	0.605	0.578	0.563	0.025	0.269	0.243	0.325	0.313
3/8	0.708	0.671	0.656	0.031	0.312	0.281	0.387	0.375	3/64
7/16	0.826	0.781	0.766	0.036	0.364	0.328	0.450	0.438	3/64
1/2	0.945	0.890	0.875	0.042	0.417	0.375	0.515	0.500	3/64
9/16	1.045	1.000	0.969	0.045	0.461	0.416	0.578	0.563	5/64
5/8	1.147	1.094	1.063	0.050	0.506	0.456	0.640	0.625	5/64
3/4	1.303	1.250	1.219	0.050	0.541	0.491	0.765	0.750	5/64
7/8	1.512	1.469	1.406	0.063	0.626	0.563	0.906	0.875	3/32
1	1.700	1.656	1.594	0.063	0.690	0.627	1.031	1.000	3/32

### A325 Domestic Structural Bolts

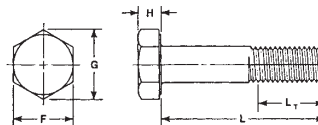

Basic Size	F Width Across Flats		G Width Across Corners		H Height		L <sub>T</sub> Thread Length
	Max.	Min.	Max.	Min.	Max.	Min.	Basic
	1/2 - 13	0.875	0.850	1.010	0.969	0.323	0.302
5/8 - 11	1.062	1.031	1.227	1.175	0.403	0.378	1.25
3/4 - 10	1.250	1.212	1.443	1.383	0.483	0.455	1.38
7/8 - 9	1.438	1.394	1.660	1.589	0.563	0.531	1.50
1 - 8	1.625	1.575	1.876	1.796	0.627	0.591	1.75
1-1/8 - 7	1.812	1.756	2.093	2.002	0.718	0.658	2.00
1-1/4 - 7	2.000	1.938	2.309	2.209	0.813	0.749	2.00
1-3/8 - 6	2.188	2.119	2.526	2.416	0.878	0.810	2.25
1-1/2 - 6	2.375	2.300	2.742	2.622	0.974	0.902	2.25

### Finished Hex Nuts (Gr. 2, 5 and 8) and Hex Jam Nuts

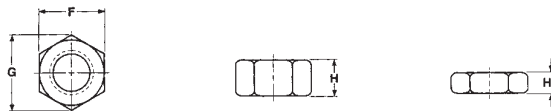

Nominal Or Basic Major Diagram Of Thread	F Width Across Flats			G Width Across Corners		H Thickness Hex Nuts & Reversible Lock Nuts			H1 Thickness Hex Jam Nuts			
	Basic	Max.	Min.	Max.	Min.	Basic	Max.	Min.	Basic	Max.	Min.	
	8	0.1640	11/32	0.344	0.332	0.397	0.378	-	0.203	0.187	-	-
10	0.1900	3/8	0.375	0.362	0.433	0.413	-	0.203	0.187	-	-	-
1/4	0.2500	7/16	0.438	0.428	0.505	0.488	7/32	0.226	0.212	5/32	0.164	0.150
5/16	0.3125	1/2	0.500	0.489	0.577	0.557	17/64	0.273	0.258	3/16	0.195	0.180
3/8	0.3750	9/16	0.562	0.551	0.650	0.628	21/64	0.337	0.320	7/32	0.227	0.210
7/16	0.4375	11/16	0.688	0.675	0.794	0.768	3/8	0.385	0.365	1/4	0.260	0.240
1/2	0.5000	3/4	0.750	0.736	0.866	0.840	7/16	0.448	0.427	5/16	0.323	0.302
9/16	0.5625	7/8	0.875	0.861	1.010	0.982	31/64	0.496	0.473	5/16	0.324	0.301
5/8	0.6250	15/16	0.938	0.922	1.083	1.051	35/64	0.559	0.535	3/8	0.387	0.363
3/4	0.7500	1-1/8	1.125	1.088	1.299	1.240	41/64	0.665	0.617	27/64	0.446	0.398
7/8	0.8750	1-5/16	1.312	1.269	1.516	1.447	3/4	0.776	0.724	31/64	0.510	0.458
1	1.0000	1-1/2	1.500	1.450	1.732	1.653	55/64	0.887	0.831	35/64	0.575	0.519
1 - 1/8	1.1250	1-11/16	1.688	1.631	1.949	1.859	31/32	0.999	0.939	39/64	0.639	0.579
1 - 1/4	1.2500	1-7/8	1.875	1.812	2.165	2.066	1-1/6	1.094	1.030	23/32	0.751	0.687
1 - 3/8	1.3750	2-1/16	2.062	1.994	2.382	2.273	1-11/64	1.206	1.138	25/32	0.815	0.747
1 - 1/2	1.5000	2-1/4	2.250	2.175	2.598	2.480	1-9/32	1.317	1.245	27/32	0.880	0.808
1 - 5/8	1.6250	2-7/16	2.438	2.356	2.815	2.686	1-25/64	1.429	1.353	29/32	0.945	0.869
1 - 3/4	1.7500	2-5/8	2.625	2.538	3.031	2.893	1-1/2	1.540	1.460	31/32	1.009	0.929
2	2.0000	3	3.000	2.900	3.464	3.306	1-23/32	1.763	1.675	1-3/32	1.138	1.050
2 - 1/4	2.2500	3-3/8	3.375	3.263	3.897	3.719	1-15/16	1.986	1.890	1-7/32	1.267	1.171
2 - 1/2	2.5000	3-3/4	3.750	3.625	4.330	4.133	2-5/32	2.209	2.105	1-11/32	1.396	1.292
2 - 3/4	2.7500	4-1/8	4.125	3.988	4.763	4.546	2-3/8	2.431	2.319	1-15/32	1.525	1.413
3	3.0000	4-1/2	4.500	4.350	5.196	4.959	2-19/32	2.654	2.534	1-19/32	1.654	1.534



### A194 Grade 2H Heavy Hex Nuts

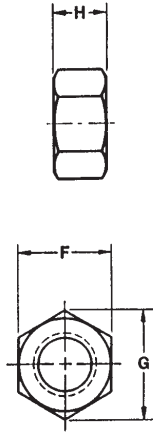

Basic Diameter	F			G		H		
	Width Across Flats			Width Across Corners		Thickness		
	Basic	Max.	Min.	Max.	Min.	Basic	Max.	Min.
1/4	1/2	0.500	0.488	0.577	0.556	15/64	0.250	0.218
5/16	9/16	0.562	0.546	0.650	0.622	19/64	0.314	0.280
3/8	11/16	0.688	0.669	0.794	0.763	23/64	0.377	0.341
7/16	3/4	0.750	0.728	0.866	0.830	27/64	0.441	0.403
1/2	7/8	0.875	0.850	1.010	0.969	31/64	0.504	0.464
9/16	15/16	0.938	0.909	1.083	1.037	35/64	0.568	0.526
5/8	1-1/16	1.063	1.031	1.227	1.175	39/64	0.631	0.587
3/4	1-1/4	1.250	1.212	1.443	1.382	47/64	0.758	0.710
7/8	1-7/16	1.438	1.394	1.660	1.589	55/64	0.885	0.833
1	1-5/8	1.625	1.575	1.876	1.796	63/64	1.012	0.956
1-1/8	1-13/16	1.812	1.756	2.093	2.002	1-7/64	1.139	1.079
1-1/4	2	2.000	1.938	2.309	2.209	1-7/32	1.251	1.187
1-3/8	2-3/16	2.188	2.119	2.526	2.416	1-11/32	1.378	1.310
1-1/2	2-3/8	2.375	2.300	2.742	2.622	1-15/32	1.505	1.433
1-5/8	2-9/16	2.562	2.481	2.959	2.828	1-19/32	1.632	1.556
1-3/4	2-3/4	2.750	2.662	3.175	3.035	1-23/32	1.759	1.679
1-7/8	2-15/16	2.938	2.844	3.392	3.242	1-27/32	1.886	1.802
2	3-1/8	3.125	3.025	3.608	3.449	1-31/32	2.013	1.925
2-1/4	3-1/2	3.500	3.388	4.041	3.862	2-13/64	2.251	2.155
2-1/2	3-7/8	3.875	3.750	4.474	4.275	2-29/64	2.505	2.401
2-3/4	4-1/4	4.250	4.112	4.907	4.688	2-45/64	2.759	2.647
3	4-5/8	4.625	4.475	5.340	5.102	2-61/64	3.013	2.893
3-1/4	5	5.000	4.838	5.774	5.515	3-3/16	3.252	3.124
3-1/2	5-3/8	5.375	5.200	6.207	5.928	3-7/16	3.506	3.370
3-3/4	5-3/4	5.750	5.562	6.640	6.341	3-11/16	3.760	3.616
4	6-1/8	6.125	5.925	7.073	6.755	3-15/16	4.014	3.862

### Square Nuts

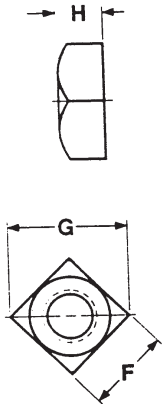

Nominal or Basic Major Dia. of Thread		F			G		H		
		Width Across Flats			Width Across Corners		Thickness		
		Basic	Max.	Min.	Max.	Min.	Basic	Max.	Min.
1/4	0.2500	7/16	0.438	0.425	0.619	0.584	7/32	0.235	0.203
5/16	0.3125	9/16	0.562	0.547	0.795	0.751	17/64	0.283	0.249
3/8	0.3750	5/8	0.625	0.606	0.884	0.832	21/64	0.346	0.310
7/16	0.4375	3/4	0.750	0.728	1.061	1.000	3/8	0.394	0.356
1/2	0.5000	13/16	0.812	0.788	1.149	1.082	7/16	0.458	0.418
5/8	0.6250	1	1.000	0.969	1.414	1.330	35/64	0.569	0.525
3/4	0.7500	1-1/8	1.125	1.088	1.591	1.494	21/32	0.680	0.632
7/8	0.8750	1-5/16	1.312	1.269	1.856	1.742	49/64	0.792	0.740
1	1.0000	1-1/2	1.500	1.450	2.121	1.991	7/8	0.903	0.847
1-1/4	1.2500	1-7/8	1.875	1.812	2.652	2.458	1-3/32	1.126	1.062
1-1/2	1.5000	2-1/4	2.250	2.175	3.182	2.956	1-5/16	1.348	1.276

### Super 9 Hex Thick Nuts

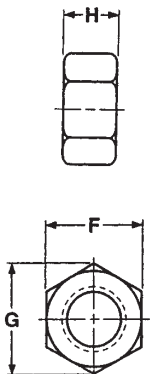

Basic Diameter	F		F		H	
	Hex Size	Width Across Flats		Thickness		
	Basic	Max.	Min.	Max.	Min.	
1/4	7/16	0.438	0.428	0.288	0.274	
5/16	1/2	0.500	0.489	0.336	0.320	
3/8	9/16	0.562	0.551	0.415	0.398	
7/16	11/16	0.688	0.675	0.463	0.444	
1/2	3/4	0.750	0.736	0.573	0.552	
9/16	7/8	0.875	0.861	0.621	0.598	
5/8	15/16	0.938	0.922	0.731	0.706	
3/4	1-1/8	1.125	1.088	0.827	0.798	
7/8	1-5/16	1.312	1.269	0.922	0.890	
1	1-1/2	1.500	1.450	1.018	0.982	
1-1/8	1-11/16	1.688	1.631	1.176	1.136	
1-1/4	1-7/8	1.875	1.812	1.272	1.228	
1-1/2	2-1/4	2.250	2.175	1.526	1.474	



### Grade C All Metal Locknuts

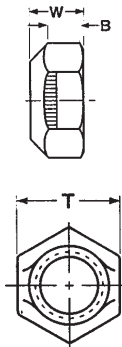

Nom. Size In Inches	T Width Across Flats			W Overall Thickness		B Hex Height
	Nom.	Max.	Min.	Max.	Min.	(Min.)
1/4	7/16	0.4385	0.428	0.226	0.212	0.145
5/16	1/2	0.5020	0.489	0.273	0.258	0.166
3/8	9/16	0.5645	0.551	0.337	0.320	0.198
7/16	11/16	0.6895	0.675	0.385	0.365	0.223
1/2	3/4	0.7520	0.736	0.448	0.427	0.262
9/16	7/8	0.8770	0.861	0.496	0.473	0.286
5/8	15/16	0.9395	0.922	0.559	0.535	0.329
3/4	1-1/8	1.1270	1.088	0.665	0.617	0.382
7/8	1-5/16	1.3145	1.2690	0.776	0.724	0.450
1	1-1/2	1.5020	1.4500	0.887	0.831	0.513

### Nylon Insert Hex Locknuts

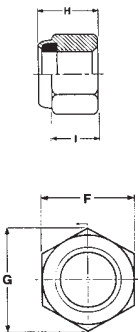

Nominal Size or Basic Thread Diameter		F Width Across Flats			H Thickness		I Side Height	G Width Across Corners
		Basic	Max.	Min.	Max.	Min.	Ref.	Ref.
4	0.1120	1/4	0.251	0.241	0.153	0.133	0.081	0.268
6	0.1380	5/16	0.313	0.302	0.188	0.168	0.103	0.399
8	0.1640	11/32	0.345	0.332	0.239	0.219	0.140	0.374
10	0.1900	3/8	0.376	0.362	0.249	0.229	0.140	0.410
1/4	0.2500	7/16	0.439	0.428	0.328	0.298	0.225	0.482
5/16	0.3125	1/2	0.502	0.489	0.359	0.329	0.250	0.552
3/8	0.3750	9/16	0.565	0.551	0.468	0.438	0.335	0.622
7/16	0.4375	11/16	0.690	0.675	0.468	0.438	0.324	0.698
1/2	0.5000	3/4	0.752	0.736	0.609	0.579	0.464	0.837
9/16	0.5625	7/8	0.877	0.861	0.656	0.626	0.469	0.978
5/8	0.6250	15/16	0.940	0.922	0.765	0.735	0.593	1.051
3/4	0.7500	1-1/8	1.127	1.088	0.890	0.860	0.742	1.191
7/8	0.8750	1-5/16	1.315	1.269	0.999	0.969	0.790	1.430
1	1.0000	1-1/2	1.502	1.450	1.078	1.061	0.825	1.615
1-1/8	1.1250	1-11/16	1.690	1.631	1.203	1.141	0.930	1.826
1-1/4	1.2500	1-7/8	1.877	1.812	1.422	1.360	1.125	2.038
1-1/2	1.5000	2-1/4	2.252	2.175	1.640	1.578	1.313	2.444

### Serrated Hex Flange Nuts

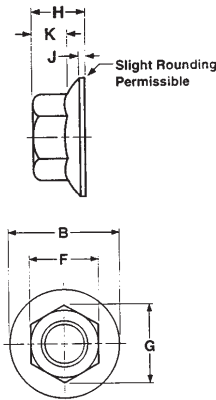

Nominal Size or Basic Major Diameter of Thread		F Width Across Flats		G Width Across Corners		B Flange Diameter		H Nut Thickness		K Wrenching Length	J Flange Thickness
		Max.	Min.	Max.	Min.	Max.	Min.	Max.	Min.	Min.	Max.
6	0.1380	0.312	0.302	0.361	0.342	0.422	0.406	0.171	0.156	0.10	0.02
8	0.1640	0.344	0.334	0.397	0.381	0.469	0.452	0.203	0.187	0.13	0.02
10	0.1900	0.375	0.365	0.433	0.416	0.500	0.480	0.219	0.203	0.13	0.03
12	0.2160	0.438	0.428	0.505	0.488	0.594	0.574	0.236	0.222	0.14	0.04
1/4	0.2500	0.438	0.428	0.505	0.488	0.594	0.574	0.236	0.222	0.14	0.04
5/16	0.3125	0.500	0.489	0.577	0.577	0.680	0.660	0.283	0.268	0.17	0.04
3/8	0.3750	0.562	0.551	0.650	0.628	0.750	0.728	0.347	0.330	0.23	0.04
7/16	0.4375	0.688	0.675	0.794	0.768	0.937	0.910	0.395	0.375	0.26	0.04
1/2	0.5000	0.750	0.736	0.866	0.840	1.031	1.000	0.458	0.437	0.31	0.05
5/8	0.6250	0.938	0.922	1.083	1.051	1.281	1.248	0.569	0.545	0.40	0.05
3/4	0.7500	1.125	1.088	1.299	1.240	1.500	1.460	0.675	0.627	0.46	0.06

### Castle Nuts

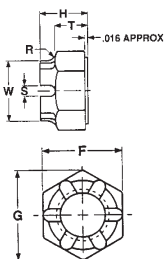

Nominal Size or Basic Major Dia. Of Thread		F Width Across Flats			G Width Across Corners		H Thickness			T Unslotted Thickness And Height of Flat			S Width of Slot		R Radius Of Fillet	W Dia. of Cylindrical	Runout of Bearing Surface FIR
		Basic	Max.	Min.	Max.	Min.	Basic	Max.	Min.	Nom.	Max.	Min.	Max.	Min.	± .010	Min.	Max.
5/8	0.6250	15/16	0.938	0.922	1.083	1.051	23/32	0.731	0.706	1/2	0.51	0.49	0.24	0.18	0.156	0.797	0.021
3/4	0.7500	1-1/8	1.125	1.088	1.299	1.240	13/16	0.827	0.798	9/16	0.57	0.55	0.24	0.18	0.188	0.941	0.023
7/8	0.8750	1-5/16	1.312	1.269	1.516	1.447	29/32	0.922	0.890	21/32	0.67	0.64	0.24	0.18	0.188	1.097	0.025
1	1.0000	1-1/2	1.500	1.450	1.732	1.653	1	1.018	0.982	23/32	0.73	0.70	0.30	0.24	0.188	1.254	0.027



### Slotted Hex Nuts

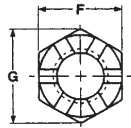
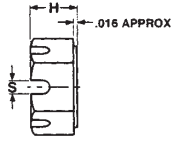

Normal Size or Basic Major Dia. Of Thread	F			G		H			T		S		Runout Of Bearing Surface FIM	
	Width Across Flats			Width Across Corners		Thickness			Unslotted Thickness		Width Of Slot			
	Basic	Max.	Min.	Max.	Min.	Basic	Max.	Min.	Max.	Min.	Max.	Min.	Max.	
3/8	0.3750	9/16	0.562	0.551	0.650	0.628	21/64	0.337	0.320	0.21	0.19	0.15	0.12	0.018
7/16	0.4375	11/16	0.688	0.675	0.794	0.768	3/8	0.385	0.365	0.23	0.21	0.15	0.12	0.018
1/2	0.5000	3/4	0.750	0.736	0.866	0.840	7/16	0.448	0.427	0.29	0.27	0.18	0.15	0.019
5/8	0.6250	15/16	0.938	0.922	1.083	1.051	35/64	0.559	0.535	0.34	0.32	0.24	0.18	0.021
3/4	0.7500	1-1/8	1.125	1.088	1.299	1.240	41/64	0.665	0.617	0.40	0.38	0.24	0.18	0.023
7/8	0.8750	1-5/16	1.312	1.269	1.516	1.447	3/4	0.776	0.724	0.52	0.49	0.24	0.18	0.025
1	1.0000	1-1/2	1.500	1.450	1.732	1.653	55/64	0.887	0.831	0.59	0.56	0.30	0.24	0.027
1-1/8	1.1250	1-11/16	1.688	1.631	1.949	1.859	31/32	0.999	0.939	0.64	0.61	0.33	0.24	0.030
1-1/4	1.2500	1-7/8	1.875	1.812	2.165	2.066	1-1/16	1.094	1.030	0.70	0.67	0.40	0.31	0.033
1-1/2	1.5000	2-1/4	2.250	2.175	2.598	2.480	1-9/32	1.317	1.245	0.86	0.82	0.46	0.37	0.039

### Hex Coupling Nuts

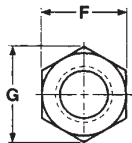
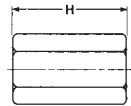

Nominal Size or Basic Major Dia of Thread	F			G		H			
	Width Across Flats			Width Across Corners		Length			
	Basic	Max.	Min.	Max.	Min.	Basic	Max.	Min.	
1/4	0.2500	3/8	0.375	0.365	0.433	0.416	3/4	0.76	0.74
5/16	0.3125	1/2	0.500	0.489	0.577	0.557	15/16	0.95	0.93
3/8	0.3750	9/16	0.562	0.551	0.650	0.628	1-1/8	1.13	1.11
1/2	0.5000	3/4	0.750	0.736	0.866	0.839	1-1/2	1.51	1.49
5/8	0.6250	15/16	0.938	0.922	1.083	1.051	1-7/8	1.89	1.86
3/4	0.7500	1-1/8	1.125	1.088	1.299	1.240	2-1/4	2.27	2.22
1	1.0000	1-1/2	1.500	1.450	1.732	1.653	3	3.03	2.97

### A563 Domestic Grade C Heavy Hex Nuts - "Structural"

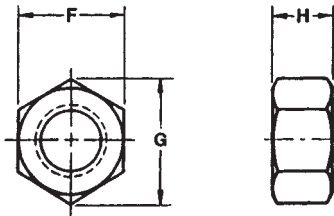

Basic Diameter	F		G		H	
	Width Across Flats		Width Across Corners		Thickness	
	Max.	Min.	Max.	Min.	Max.	Min.
1/2-13	0.875	0.850	1.010	0.969	0.504	0.464
5/8-11	1.062	1.031	1.227	1.175	0.631	0.587
3/4-10	1.250	1.212	1.443	1.382	0.758	0.710
7/8-9	1.437	1.394	1.660	1.589	0.885	0.833
1-8	1.625	1.575	1.876	1.796	1.012	0.956
1-1/8-7	1.812	1.756	2.093	2.002	1.139	1.079
1-1/4-7	2.000	1.938	2.309	2.209	1.251	1.187
1-3/8-6	2.188	2.119	2.526	2.416	1.378	1.310
1-1/2-6	2.375	2.300	2.742	2.622	1.505	1.433

### Acorn (Cap) Nuts

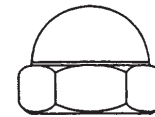

Basic Bolt Size	A	B
	Width Across Flats	Overall Height
6-32	5/16	1/4
8-32	5/16	1/4
10-24	3/8	9/32
10/32	3/8	11/32
1/4-20	7/16	21/64
5/16-18	9/16	3/8
3/8-16	5/8	27/64
1/2-13	3/4	9/16
5/8-11	15/16	51/64



### Grade G Hex Flange Locknuts

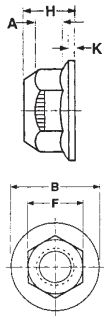

Nom. Size In Inches	F			B	H		A	K
	Width Across Flats			Flange Diam.	Overall Thickness		Hex Height	Flange Thick.
	Nom.	Max.	Min.	(Max.)	Max.	Min.	(Min.)	(Min.)
3/8	9/16	0.5645	0.551	0.810	0.425	0.404	0.200	0.060
1/2	3/4	0.7520	0.736	1.070	0.555	0.528	0.260	0.080
5/8	15/16	0.9395	0.922	1.330	0.690	0.646	0.320	0.100
3/4	1-1/8	1.1270	1.088	1.585	0.825	0.742	0.380	0.110

® Stover is a registered trademark of RB&W Corporation.

### Hex Nuts w/ Ext. Tooth L/W Attached

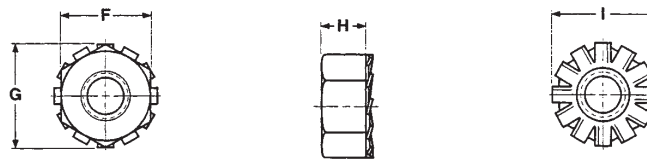

Nominal Size or Basic Thread Diameter		F			G		H		I
		Width Across Flats			Width Across Corners		Thickness		Washer Diameter
		Basic	Max.	Min.	Max.	Min.	Max.	Min.	Ref.
4	0.1120	1/4	0.250	0.241	0.289	0.275	0.098	0.087	0.281
6	0.1380	5/16	0.312	0.302	0.361	0.344	0.114	0.102	0.344
8	0.1640	11/32	0.344	0.332	0.397	0.378	0.130	0.117	0.375
10	0.1900	3/8	0.375	0.362	0.433	0.413	0.130	0.117	0.406
1/4	0.2500	7/16	0.438	0.423	0.505	0.482	0.193	0.178	0.500
5/16	0.3125	1/2	0.500	0.489	0.577	0.557	0.273	0.258	0.578
3/8	0.3750	9/16	0.562	0.551	0.650	0.628	0.385	0.365	0.656

### Tee Nuts

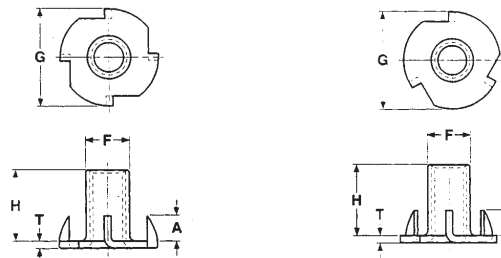

Thread Size	G	H	F	A	T	Drill Size	Lbs. Per M Pcs.
	Flange Dia.	Barrel Height	Barrel Diam.	Prong Height	Material Thickness		
10 - 24	3/4	5/16	.243	7/32	.040	1/4	7
10 - 24	3/4	5/16	.243	7/32	.040	1/4	7
10 - 32	3/4	5/16	.243	7/32	.040	1/4	7
10 - 32	3/4	5/16	.243	7/32	.040	1/4	7
1/4 - 20	3/4	5/16	.305	7/32	.047	5/16	9
1/4 - 20	3/4	5/16	.305	7/32	.047	5/16	9
1/4 - 20	3/4	7/16	.305	5/16	.047	5/16	9
1/4 - 20	3/4	7/16	.305	1/4	.047	5/16	9
5/16 - 18	7/8	3/8	.390	1/4	.063	25/64	14
5/16 - 18	7/8	3/8	.390	1/4	.063	25/64	14
5/16 - 18	7/8	5/8	.390	5/16	.063	25/64	18
3/8 - 16	1	7/16	.440	11/32	.063	29/64	19



### Flexloc® Thin Height Light Hex Locknuts

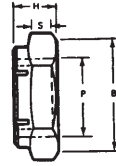
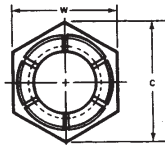

Basic Diameter	W		C	H	S	P	B
	Width Across Flats		Width Across Corners	Thickness	Thickness	Diameter	Diameter
	Max.	Min.	Min.	Max.	Min.	Max.	Min
#6	0.313	0.305	0.347	0.141	0.036	0.181	0.305
#8	0.345	0.336	0.383	0.188	0.065	0.208	0.336
#10	0.376	0.367	0.419	0.188	0.070	0.230	0.367
#12	0.439	0.430	0.491	0.209	0.071	0.258	0.430
1/4	0.439	0.430	0.491	0.219	0.075	0.293	0.430
5/16	0.502	0.492	0.561	0.266	0.097	0.356	0.492
3/8	0.564	0.553	0.631	0.282	0.108	0.418	0.553
7/16	0.627	0.616	0.703	0.328	0.120	0.487	0.616
1/2	0.752	0.741	0.846	0.328	0.121	0.551	0.741
9/16	0.877	0.865	0.987	0.368	0.135	0.614	0.865
5/8	0.940	0.928	1.059	0.399	0.147	0.676	0.928
3/4	1.064	1.052	1.200	0.415	0.155	0.807	1.052
7/8	1.252	1.239	1.414	0.477	0.166	0.938	1.239
1	1.440	1.427	1.628	0.571	0.218	1.064	1.427

### Flexloc® Full Height Heavy-Duty Hex Locknuts

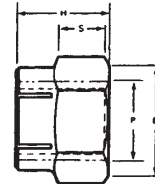
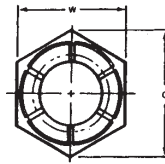

Basic Diameter	W		C	H	S	P	B
	Width Across Flats		Width Across Corners	Thickness	Thickness	Diameter	Diameter
	Max.	Min.	Min.	Max.	Min.	Max.	Min
1/4	0.502	0.492	0.561	0.290	0.094	0.293	0.492
5/16	0.564	0.553	0.631	0.321	0.113	0.356	0.553
3/8	0.627	0.616	0.703	0.384	0.144	0.418	0.616
7/16	0.752	0.741	0.846	0.446	0.163	0.487	0.741
1/2	0.814	0.803	0.917	0.509	0.196	0.551	0.803
9/16	0.940	0.928	1.059	0.571	0.216	0.614	0.928
5/8	1.002	0.990	1.130	0.634	0.245	0.676	0.990
3/4	1.127	1.115	1.271	0.759	0.325	0.807	1.115
7/8	1.314	1.301	1.484	0.884	0.397	0.938	1.301
1	1.502	1.489	1.699	1.009	0.462	1.064	1.489
1-1/8	1.814	1.801	2.056	1.134	0.549	1.191	1.801
1-1/4	2.002	1.988	2.269	1.259	0.616	1.315	1.988
1-3/8	2.190	2.176	2.484	1.384	0.684	1.440	2.176
1-1/2	2.377	2.363	2.697	1.509	0.748	1.565	2.363
1-5/8	2.564	2.549	2.909	1.634	0.814	1.690	2.549
1-3/4	2.752	2.737	3.124	1.759	0.882	1.815	2.737
1-7/8	2.940	2.925	3.338	1.884	0.950	1.940	2.925
2	3.127	3.112	3.552	2.009	1.018	2.065	3.112



### Flexloc® Full Height Light Hex Locknuts

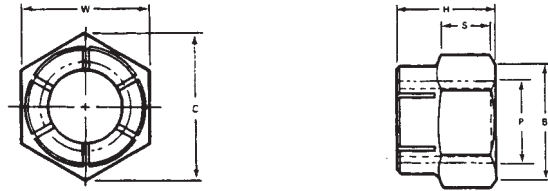

Basic Diameter	W		C	H	S	P	B
	Width Across Flats		Width Across Corners	Thickness	Thickness	Diameter	Diameter
	Max.	Min.	Min.	Max.	Min.	Max.	Min.
#2	0.251	0.243	0.277	0.155	0.050	0.129	0.243
#3	0.251	0.243	0.277	0.155	0.050	0.142	0.243
#4	0.251	0.243	0.277	0.155	0.050	0.155	0.243
#5	0.251	0.243	0.277	0.155	0.052	0.168	0.243
#6	0.313	0.305	0.347	0.180	0.075	0.181	0.305
#8	0.345	0.336	0.383	0.243	0.085	0.208	0.336
#10	0.376	0.367	0.419	0.243	0.105	0.230	0.367
#12	0.439	0.430	0.491	0.290	0.122	0.258	0.430
1/4	0.439	0.430	0.491	0.290	0.122	0.293	0.430
5/16	0.502	0.492	0.561	0.353	0.150	0.356	0.492
3/8	0.564	0.553	0.631	0.462	0.210	0.418	0.553
7/16	0.627	0.616	0.703	0.462	0.210	0.487	0.616
1/2	0.752	0.741	0.846	0.602	0.285	0.551	0.741
9/16	0.877	0.865	0.987	0.696	0.385	0.614	0.865
5/8	0.940	0.928	1.059	0.759	0.410	0.676	0.928
3/4	1.064	1.052	1.200	0.884	0.505	0.807	1.052
7/8	1.252	1.239	1.414	1.009	0.570	0.938	1.239
1	1.440	1.427	1.628	1.134	0.635	1.064	1.427

### Wing Nuts Cold Forged

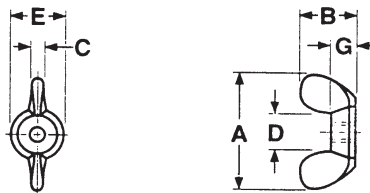

Nominal Size or Basic Major Diameter of Thread	Threads Per Inch	A		B		C		D		E		G		
		Wing Spread		Wing Height		Wing Thickness		Between Wings		Boss Diameter		Boss Height		
		Max.	Min.	Max.	Min.	Max.	Min.	Max.	Min.	Max.	Min.	Max.	Min.	
6	0.1380	32	0.72	0.59	0.41	0.28	0.11	0.07	0.21	0.17	0.35	0.29	0.14	0.10
8	0.1640	32	0.91	0.78	0.47	0.34	0.14	0.10	0.27	0.22	0.43	0.39	0.18	0.14
10	0.1900	24 & 32	0.91	0.78	0.47	0.34	0.14	0.10	0.27	0.22	0.45	0.39	0.18	0.14
1/4	0.2500	20	1.10	0.97	0.57	0.43	0.18	0.14	0.39	0.26	0.55	0.45	0.22	0.17
5/16	0.3125	18	1.25	1.12	0.66	0.53	0.21	0.17	0.39	0.32	0.58	0.51	0.25	0.20
3/8	0.3750	16	1.44	1.31	0.79	0.65	0.24	0.20	0.48	0.42	0.71	0.64	0.30	0.26
1/2	0.5000	13	1.94	1.81	1.00	0.87	0.33	0.26	0.65	0.54	0.93	0.86	0.39	0.35
5/8	0.6250	11	2.76	2.62	1.44	1.31	0.40	0.34	0.90	0.80	1.19	1.13	0.55	0.51
3/4	0.7500	10	2.76	2.62	1.44	1.31	0.40	0.34	0.90	0.80	1.19	1.13	0.55	0.51